

INDEPENDENCE ELEMENTARY SCHOOL ARRIVAL PLAN

Below is a traffic map for arrival. The safety of students is our number one priority and is dependent upon every parent following these procedures.

Please pull up as far as possible. By doing so we can maximize the number of students getting out of cars at one time, and in turn get more students out at one time. Please do not leave your vehicle unattended. There are parking spots on the parking lot median if you need to walk your child inside.

We ask walkers/bike riders to the South of us to use the crosswalk at Bray Birch and Twin Creek. The walkers North of the school will be crossed on the sidewalk at Vienna Apple and Bray Birch. Children will not be allowed to cross traffic or go through the parking lot without adult supervision.

If you park and walk into the building with your child, we ask that you use the provided crosswalks. Thank you for your cooperation and helping each student arrive safely.

Designated drop off for South walkers, bike riders, daycare, and bus riders only.

ARRIVAL KINDER-4TH SOUTH WALKERS

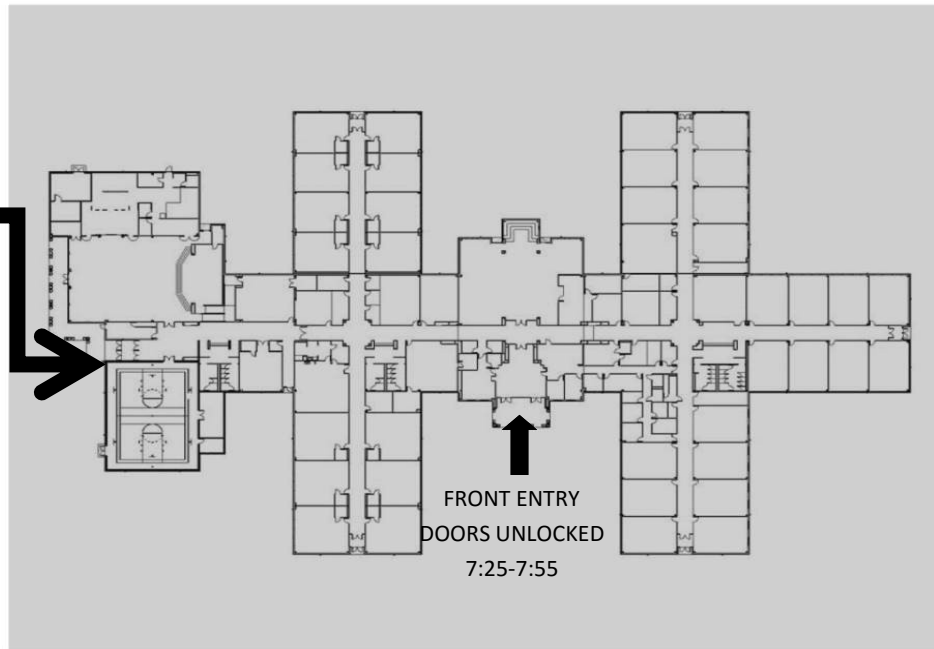

We use one lane only. Please watch for staff members on duty to direct you when to pull forward and when to let students out of your car.

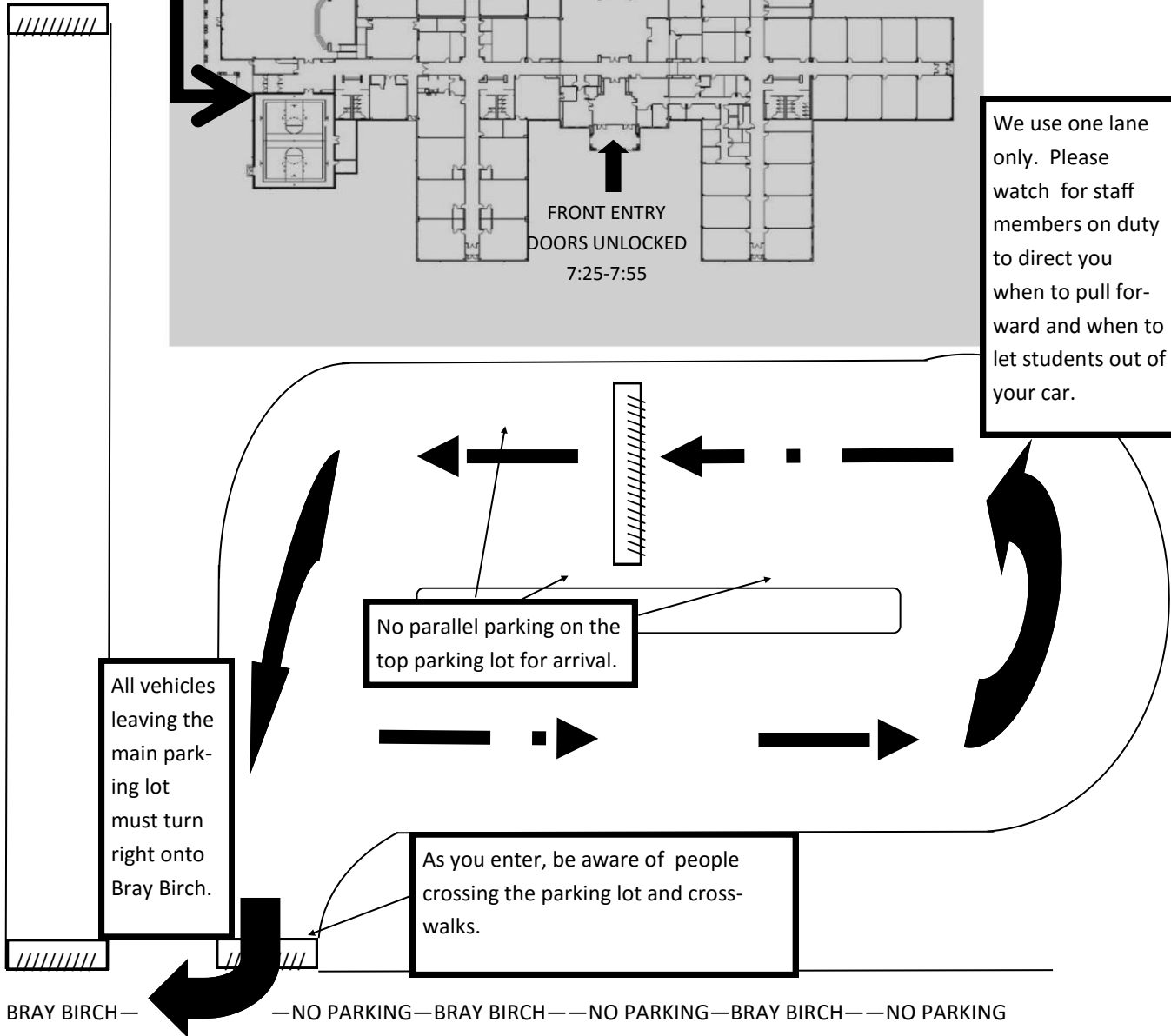

BRAY BIRCH — NO PARKING — BRAY BIRCH — NO PARKING — BRAY BIRCH — NO PARKING